



Hella marine

Vision and Innovation

Commercial Vessel Lighting



World Leading LED Lamp Technology - Efficient & Ultra Durable



Navigation Lamps • Deck Floodlights • Utility Lighting • Interior Lighting • Courtesy Lighting

www.hellamarine.com

Vision and Innovation

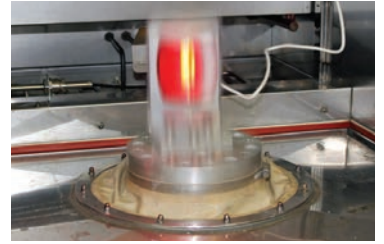

A marine lighting specialist since 1925, Hella marine draws product and technical expertise from manufacturing plants in Austria, Finland and New Zealand.

A division of the respected HELLA multinational, Hella marine's core competence is the development, production and distribution of advanced marine lighting products utilizing the latest LED (Light Emitting Diode) technology. Electronic and LED expertise is channelled to provide world leading products that set benchmarks for reliability, safety and energy efficiency and to exceed customer expectations for outstanding service and support.

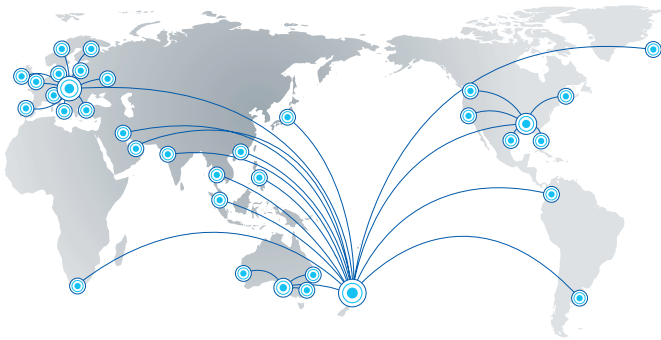

Hella marine is certified to the international quality standard ISO 9001:2015 for:

'The Design and Manufacture of Marine Navigation Lighting, General Lighting, LED Based Lighting and Associated Electronic Control Units. The Design and Manufacture of Automotive Lighting and Signalling Equipment, General Lighting, Optical Products and Plastic Components.'

ISO 9001

BUREAU VERITAS
Certification

N° 201297



The Hella marine Advantage

At sea, power is often a scarce resource. Highly efficient and durable LED lighting has a substantial role to play in conserving energy and enhancing a vessel without sacrificing functionality or compromising safety. Our vision is to provide world leading products that set benchmarks for quality, reliability, safety and energy efficiency while satisfying customer expectations for outstanding service and support. Hella marine 'Fit and Forget' LED lighting is firmly established as the solution of choice that meets long term reliability and economic considerations for astute owners and operators.

5 YR
WARRANTY

5 Year Warranty

All Hella marine LED based lighting products carry a 5 Year Warranty providing peace of mind that the product will stand the test of time.

For more information visit:

<http://www.hellamarine.com/en/about/warranty/>

LED

Class Leading Efficiency

Combining efficient LED sources with advanced optic technology, Hella marine LED products deliver more light output per watt than incandescent based lamps with significant energy savings. Ultra low heat signatures reduce heat onboard and prevent damage to surrounding materials.

IP67
COMPLETELY
SEALED

IP67 - Completely Sealed

Preventing moisture from corroding internal LED electronics is vital for long term durability in the harsh marine environment. Hella marine products are completely sealed and purpose designed for interior or exterior use, wet or dry.

CE

Electromagnetic Compatibility (EMC)

All Hella marine LED products are designed with components that suppress possible interference, both emission as well as susceptibility to emissions, to the limits prescribed in international standards. This prevents possible interference with radio, communication, navigation and other electrical equipment onboard.

UV
RESISTANT

Outstanding UV and Impact Resistance

Hella marine lamps utilise advanced impact resistant polymers that will not yellow or deteriorate in the harsh marine environment.

Not All LED Lights are Created Equal



It is common knowledge that LEDs offer many advantages over traditional incandescent bulbs including significantly reduced power consumption, increased reliability, a reduction in radiated heat and attractive ambient effects. But it's important to know not all LEDs are created equal.

When comparing one LED product to another it is important to not just look at the initial purchase cost but consider the full life expectancy and what attributes combine to make a quality LED product.

There are a number of key points to consider when selecting LED lighting for marine interior and exterior applications.

Some specific points to consider when comparing products are:

- What is the application
- Where are they being used
- What sort of light do you desire

Low cost LED products are generally cheap because they have used low quality materials and components. Even though by nature LEDs are solid state devices and are sold on the promise of longer life, the reality is they are usually only as good as the weakest component in the device.

Corrosion, moisture, heat, vibration and voltage fluctuations can all affect the life and performance of a LED device so it is important that all these factors are managed in order to provide continuous long life.

The following attributes should be considered to ensure the product fits the desired brief.

Light Output, Beam Angle, Power Consumption

If possible try and compare the lumens per watt to get an accurate measurement of what percentage of power is being used to effectively generate light. Also select a light with a lens and optic design that reduces eye strain and a light pattern to suit your application.

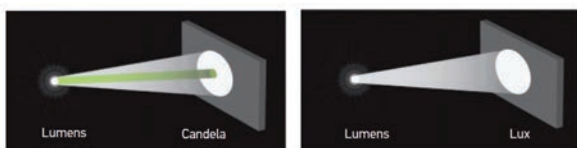

Sealing (IP Rating)

As LEDs are electronic devices it is important to protect them from moisture and other contaminants that will degrade or harm the lamp. In a marine environment this is even more important as the chance of getting water, condensation or salt spray around the lamp is highly likely even in interior applications. Look for lamps with an IP67 rating.



IP30 (open)

IP54 (partially sealed)

IP67 (completely sealed)

Materials

Durable housings are needed to protect internal components and electronics. Look for lamps that are made of materials that are corrosion resistant e.g. salt, UV and chemical. These can affect the appearance of the lamp with unsightly blemishes or corrosion but also compromise the housing and allow water or other contaminants to ingress and effectively cause the lamp to fail.



Rust quickly forms on non-marine grade materials



A powder coated aluminium floodlight with housing degradation

Electro Magnetic Interference (EMI)

Lamps poorly designed and not meeting international standards can cause EMI which may affect your VHF and other electronics which can be hazardous in remote locations. Check that the lamp has been tested and certified to the International standard CE.



Poorly designed LED lamps can interfere with communications.

Warranty

Depending on the brand of LED lamp purchased you can expect between a 12 month and 5 year warranty and this commitment of the manufacturer will be an indication of the confidence level a manufacturer places in the long-term durability of the product. Buy from a trusted brand which has a reputation to stand behind their products.

Cost

All these considerations add to the overall cost and value of a product and if a lamp fails and you need to purchase another lamp and install it any potential savings are lost. It is important to not only consider the initial expense but the life time cost of the lamp or your vessel.

NAVIGATION LAMPS

Ultra durable, power saving LED navigation lamps for enhanced safety. NaviLED PRO lamps are proven worldwide on search and rescue, military and commercial vessels.



Designed and manufactured in New Zealand and proven in the harshest conditions worldwide, Hella marine LED navigation lamps provide power saving, highly visible and ultra durable lighting for reliability and safety at sea.



Combining efficient LED light sources with advanced optic technology, Hella marine LED products deliver more light per watt than traditional bulb lamps and thus provide considerable power saving. Each lamp is a completely sealed unit. Proven design, precision engineering and the use of high impact acrylic materials ensure superior resistance to water, impact, UV and wear and tear. Advanced Multivolt™ circuitry provides reliable illumination across 9-33 volts DC. Multivolt™ LED lamps can be connected to 12 or 24 volt systems providing full light performance even during low battery voltage and voltage drop over long cable runs.

- IP67 - Completely sealed
- Ultra low power consumption
- UV, corrosion and impact resistant
- Pre-wired with marine cable
- Multivolt™ 9-33 volts DC
- Reverse polarity and spike protected
- Internationally approved
- 5 Year warranty

Lamp Type	NaviLED PRO	NaviLED 360	NaviLED Compact
Material Description	High impact acrylic or ultra heavy duty Grilamid® lens	High impact acrylic lens	High impact acrylic lens
Visible Distance	2, 3 or 5 Nautical Mile options	2 Nautical Mile	2 Nautical Mile
Cable	Pre-wired with marine cable		
Operating Voltage	Multivolt™ 9-33V DC		
Spike Protection	+500 volts		
Reverse Polarity Protection	-700 volts	-500 volts	-700 volts
Degree of Protection	IP67 - Completely sealed		
Power Consumption	Port/Starboard/Stern <2W 3NM Masthead <2.5W 5NM Masthead <4W	<1.5W	Port/Starboard combined <2W Stern or Towing each <2W
Weight (including cable)	250g	150g	60g
Approvals	IMO COLREG, USCG, RINA (I), ABYC A-16, NMSC, BV, WHEELMARK		

Lamp Requirements by Vessel Length

For vessels less than 50 meters in length overall, IMO COLREG 72 describes the following minimum visible distances for navigation lamps. Supplementary national approvals may also apply.

Vessels 12-20 meters / 40-65 feet in length:

- 2NM - White, Red, Green All Round lamps
- 3NM - Masthead lamp
- 2NM - Port and Starboard lamps
- 2NM - Stern lamp
- 2NM - Tri Colour lamp (Sailing vessels under sail only)

Vessels 20-50 meters / 65-150 feet in length:

- 2NM - White, Red, Green All Round lamps
- 5NM - Masthead lamp
- 2NM - Port and Starboard lamps
- 2NM - Stern lamp

NAViLED PRO

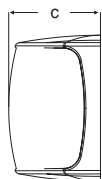
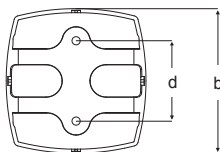
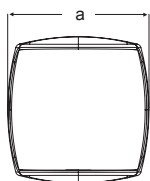

Dimensions
 a = 87mm / 3.43"
 b = 90mm / 3.54"
 c = 57mm / 2.25"
 d = 50mm / 1.97"

NavILED PRO Navigation Lamps - Acrylic Lens

Lamp Type	Visibility	Black Shroud	White Shroud
Port	2 NM	2LT 959 900-001	2LT 959 900-011
Port	3 NM	2LT 959 900-201	2LT 959 900-211
Starboard	2 NM	2LT 959 908-001	2LT 959 908-011
Starboard	3 NM	2LT 959 908-201	2LT 959 908-211
Stern	2 NM	2LT 959 909-001	2LT 959 909-011
Stern	3 NM	2LT 959 909-201	2LT 959 909-211
Masthead	3 NM	2LT 959 940-201	2LT 959 940-211



NavILED PRO Navigation Lamps - HD Grilamid Lens

Lamp Type	Visibility	Black Shroud	White Shroud
Port	2 NM	2LT 959 900-601	2LT 959 900-611
Starboard	2 NM	2LT 959 908-601	2LT 959 908-611
Stern	2 NM	2LT 959 909-601	2LT 959 909-611
Bi-Colour	2 NM	2LT 959 941-001	2LT 959 941-011
Masthead	3 NM	2LT 959 940-601	2LT 959 940-611
Masthead	5 NM	2LT 959 940-401	2LT 959 940-411

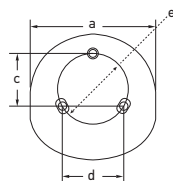
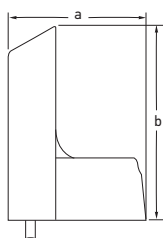

Dimensions
 a = 90mm / 3.54"
 b = 128mm / 5"
 c = 38mm / 1.5"
 d = 44mm / 1.73"
 e = 50.8mm / 2"

NavILED PRO Deck Mount Adaptor

Black Housing	White Housing
8HG 241 287-802	8HG 241 287-812

New



Lamp not included

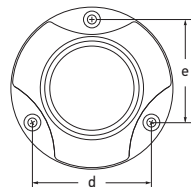
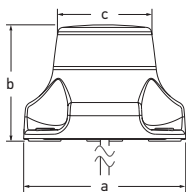

Dimensions
 a = 90mm / 3.54"
 b = 68mm / 2.68"
 c = 53mm / 2.09"
 d = 66mm / 2.60" (mounting holes)
 e = 57mm / 2.24" (mounting holes)

NAViLED 360

NavILED 360 PRO All Round Navigation Lamps

Light Colour	Visibility	Black Base	White Base
White	2 NM	2LT 980 910-121	2LT 980 910-131
Red	2 NM	2LT 980 910-521	2LT 980 910-531
Green	2 NM	2LT 980 910-321	2LT 980 910-331

Fixed Pole 2 Nautical Mile Anchor Lamps

Overall Length	Visibility	Black Base	White Base
Fixed 6"/167mm	2 NM	2LT 980 960-201	2LT 980 960-211

Robust fixed pole mount with two counter-sunk holes.



New

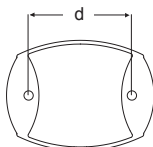
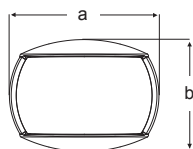

Dimensions
 a = 71mm / 2.80"
 b = 53mm / 2.09"
 c = 33mm / 1.30"
 d = 50mm / 1.97"

NAViLED COMPACT

NavILED Navigation Lamps

Lamp Type	Visibility	Black Shroud	White Shroud
Port	2 NM	2LT 980 520-001	2LT 980 520-011
Starboard	2 NM	2LT 980 520-201	2LT 980 520-211
Stern	2 NM	2LT 980 520-501	2LT 980 520-511
Towing	2 NM	2LT 980 520-601	2LT 980 520-611



Bulk OEM packages available for all LED navigation lamps. Enquire with your Hella marine representative or distributor.

UTILITY LIGHTING

Heavy duty marine lamps offer outstanding light intensity, class leading efficiency and proven durability.



DuraLED

DuraLED lamps provide powerful white light purpose designed for engine rooms and many other heavy duty applications where reliability must not be compromised.

Advanced Hella marine lens and optic engineering ensures an ultra wide spread of light without glare or harsh point sources. Each lamp is IP67 (completely sealed) and highly impact and shock resistant, ensuring an ultra long service life.

Multivolt™ circuitry provides constant illumination and circuit protection on 12 or 24 volt DC systems, even under severe voltage fluctuations. Spike protection, reverse polarity protection and over-voltage protection are all built-in benefits of the sophisticated electronics inside.

DuraLED lamps are surface mounted and feature a unique installation system where the fastening load is taken up by a heavy duty nylon bush to eliminate possible stress on the lamp housing.



- IP67 - Completely sealed
- Ultra low power consumption
- UV, corrosion and impact resistant
- Pre-wired with marine cable
- Multivolt™ suitable for 12 and 24 volt systems
- Reverse polarity and spike protected
- 5 Year warranty

Lamp Type	DuraLED 12	DuraLED 20	DuraLED 36	DuraLED 50
Light Output @1m	60cd	390cd	600cd	780cd
Light Angle	120°	64°		36° or 100°
Colour Temperature	5000 K (White)			
Material Description	UV resistant enhanced impact acrylic			
Cable	Pre-wired with marine cable			
Operating Voltage	12 / 24V DC	9-33V DC		
Power Consumption	<2.5W (<0.20A@12V)	<4W (<0.33A@12V)	<7W (<0.51A@12V)	<10W (<0.80A@12V)
Product Dimensions (WxHxD) - mm	140 x 65 x 32 mm	177 x 100 x 30 mm		220 x 96 x 31 mm
- inches	5.51 x 2.56 x 1.26"	6.97 x 3.94 x 1.18"		8.66 x 3.78 x 1.22"
Weight (including cable)	115g	345g		450g
Operating Temperature	-40°C to +60°C / -40°F to 140°F			
Degree of Protection	IP67 - Completely sealed			
Approvals	CE, ISO 8846 (Ignition Protection)			



DuraLed12

DuraLED 12 Lamps				
Switch Type	LED Colour	Voltage	White Shroud	Black Shroud
No Switch	White	12 / 24V DC	2JA 959 700-101	2JA 959 700-121
No Switch	Warm White	12 / 24V DC	2JA 959 700-701	2JA 959 700-711
With Switch	White	12 / 24V DC	2JA 980 704-001	2JA 980 704-021
With Switch	Warm White	12 / 24V DC	2JA 980 704-501	2JA 980 704-521

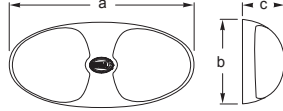
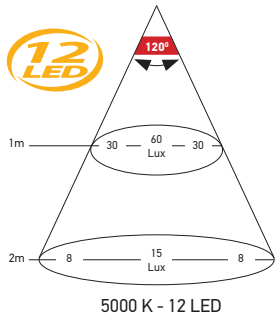

Dimensions
 a= 140mm / 5.51"
 b= 65.0mm / 2.56"
 c= 32.0mm / 1.26"



DuraLED 20 Lamps			
Number of LEDs	LED Colour	Voltage	White Shroud
20	White	9-33V DC	2JA 980 608-001

DuraLed20

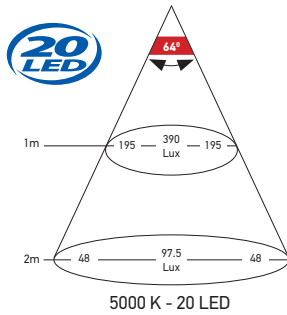

DuraLED 36 Lamps			
Number of LEDs	LED Colour	Voltage	White Shroud
36	White	9-33V DC	2JA 959 037-521

DuraLed36

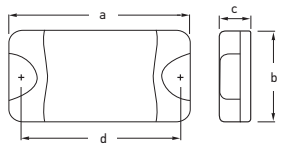
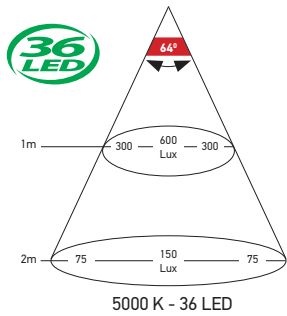

Dimensions
 a= 177mm / 6.97"
 b= 100mm / 3.94"
 c= 30.0mm / 1.18"
 d= 148mm / 5.83"



DuraLED 50 Lamps			
Number of LEDs	Lens Options	Voltage	White Shroud
50 - White	Spread	9-33V DC	2JA 980 629-001
50 - White	Wide spread	9-33V DC	2JA 980 629-501
50- Blue	Spread	9-33V DC	2JA 980 629-111
30-White 20-Red	Spread	9-33V DC	2JA 980 604-061

DuraLed50

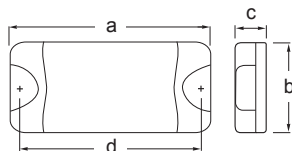
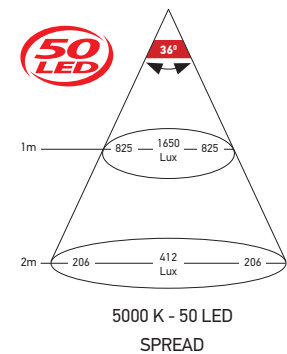

Dimensions:
 a = 222mm / 8.74"
 b = 96mm / 3.78"
 c = 25mm / 0.98"
 d = 193mm / 7.60"

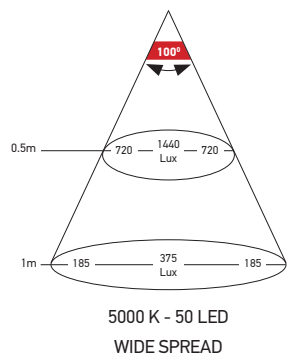

STRIP LIGHTING

Easy to install and completely sealed these Surface Strip lamps feature a waterproof switch and dual colour options.

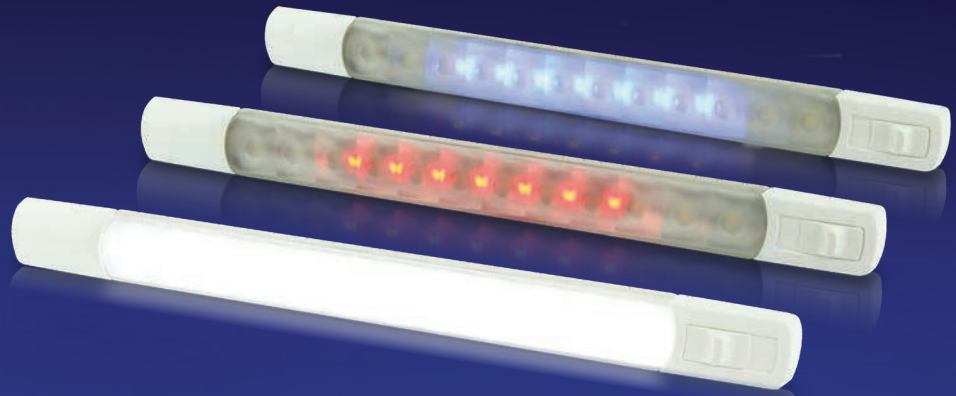

The Surface Mount Strip lamps from Hella marine feature an innovative waterproof switch for reliable operation. Completely sealed, UV and corrosion resistant with an ultra low profile design make these lamps easy to install and ideal for interior and exterior, wet or dry applications.

Offering exceptional light output and an ultra-low power consumption of <3W, these lamps are an ideal replacement for bulky fluorescent lighting. Producing 250 lumens (White) and offering a leading CRI rating of 85 these LEDs will enhance the appearance of your vessel and provide bright and accurate illumination.

The sealed switch system prevents moisture and other contaminants from effecting electronics, while the low profile design offers an effortless surface mount installation almost anywhere on board. Fastenings at each end of the lamp body are covered by snap-on end caps for a clean and modern appearance.



- Integrated sealed switch
- Dual colour options
- 12 high performance LEDs
- High Colour Accuracy (CRI 85)
- Low power consumption <3W
- Low profile surface mount design
- Completely sealed
- UV and impact resistant
- 5 Year Warranty

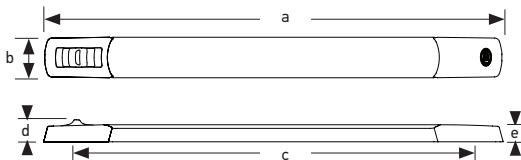

Dimensions
 a= 283mm / 11.14"
 b= 25.0mm / 1.0"
 c= 265mm / 10.43"
 d= 14.0mm / 0.55" Switch Cap
 e= 11.0mm / 0.43" Plain Cap

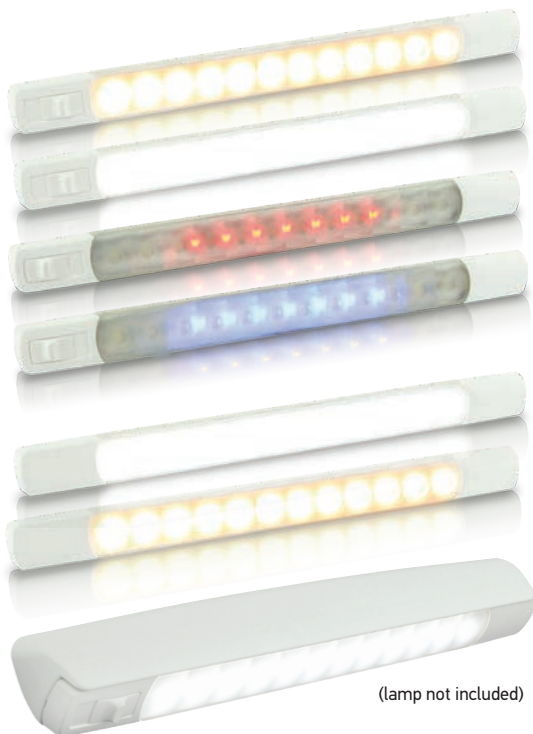

(lamp not included)

Surface Mount Strip Lamps with Switches		
LED Colours	12V Part Number	24V Part Number
White	2JA 958 123-001	2JA 958 123-401
White / Red	2JA 958 121-001	2JA 958 121-401
White / Blue	2JA 958 121-011	2JA 958 121-411
Warm White	2JA 958 123-101	2JA 958 123-501
Warm White / Red	2JA 958 121-101	2JA 958 121-501
Warm White / Blue	2JA 958 121-111	2JA 958 121-511

Surface Mount Strip Lamps - Non-switched		
LED Colours	12V Part Number	24V Part Number
White	2JA 958 124-001	2JA 958 124-401
Warm White	2JA 958 124-101	2JA 958 124-501

Accessories to suit surface mount strip lamps		
Description	Colour	Part Number
45° Mounting Bracket	White	8HG 958 000-011

COURTESY & SAFETY LAMPS

Extremely efficient, ultra-reliable and discreet - these lamps are ideal for courtesy, chart table and emergency lighting.

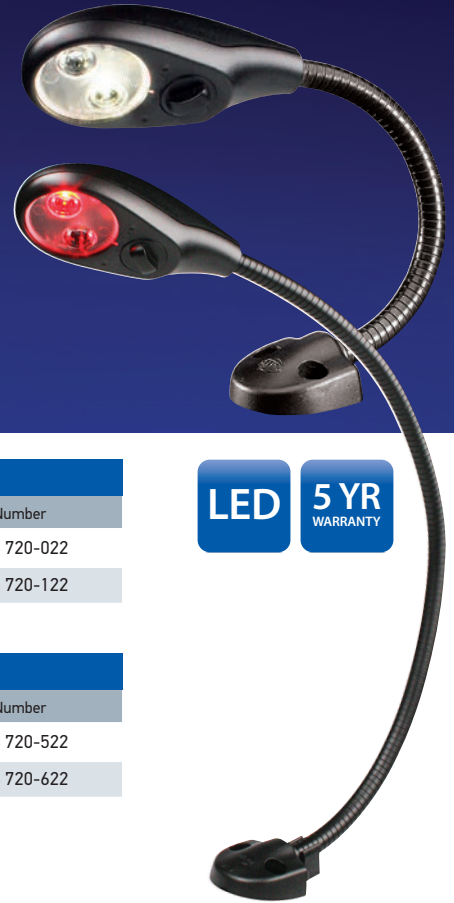

Dual colour LED chart table lamps feature a rotary dial for on/off red/white light control and dimming.

White Chart Table LED Lamps		
Voltage	Shaft Length	Part Number
9-31V DC	6" / 150 mm	2JA 346 720-022
9-31V DC	16" / 400 mm	2JA 346 720-122

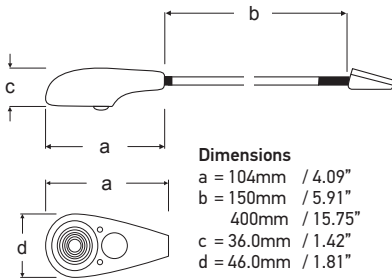

White / Red Light Chart Table LED Lamps		
Voltage	Shaft Length	Part Number
9-31V DC	6" / 150 mm	2JA 343 720-522
9-31V DC	16" / 400 mm	2JA 343 720-622

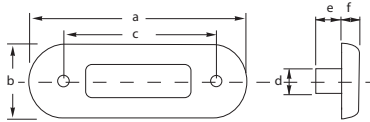

Dimensions
 a = 84mm / 3.31"
 b = 29mm / 1.14"
 c = 58mm / 2.28"
 d = 10mm / 0.39" Ø
 e = 10mm / 0.39"
 f = 9.0mm / 0.35"

Operating Voltage	12V or 24V DC systems
Power Consumption	0.5W (< 0.04A@12V / < 0.02A@24V)
Degree of Protection	IP67 - Completely sealed



LED Courtesy Lamps		
LED Colour	Voltage	Part Number
White	12 / 24V DC	2XT 980 869-301
Warm White	12 / 24V DC	2XT 980 869-401
Blue	12 / 24V DC	2XT 980 869-601
Red	12 / 24V DC	2XT 980 869-501

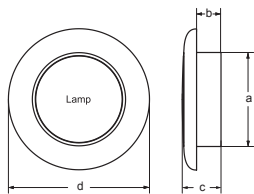

Dimensions
 a = 75mm / 2.95" plastic rim
 72mm / 2.83" with stainless steel rim
 b = 50mm / 1.97"
 c = 21mm / 0.83"
 d = 13mm / 0.51"

Operating Voltage	12V or 24V DC systems
Power Consumption	0.5W (< 0.04A@12V / < 0.02A@24V)
Degree of Protection	IP67 - Completely sealed

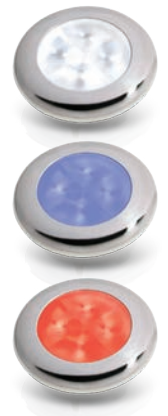

Red Light Round LED Courtesy Lamps			
LED Colour	Rim Finish	12V Part Number	24V Part Number
White	316 stainless steel	2XT 980 500-521	2XT 980 501-521
White	White plastic	2XT 980 500-541	2XT 980 501-541
White	Black plastic	2XT 980 500-551	2XT 980 501-551
Blue	316 stainless steel	2XT 980 502-221	2XT 980 503-221
Blue	White plastic	2XT 980 502-241	2XT 980 503-241
Blue	Black plastic	2XT 980 502-251	2XT 980 503-251
Red	316 stainless steel	2XT 980 507-221	2XT 980 508-221
Red	White plastic	2XT 980 507-241	2XT 980 508-241
Red	Black plastic	2XT 980 507-251	2XT 980 508-251

DOWN LIGHTING

Energy efficient, extremely reliable and completely sealed EuroLED lamps provide even illumination for both interior and exterior applications.

EuroLED75



EuroLED75 DUAL COLOUR



EuroLED95 GEN 2



EuroLED down lights maximise state of the art LED technology to provide 20W halogen comparable illumination for a fraction of the energy use.

Advanced Hella marine optics provide a wide spread of uniform illumination without glare or eye strain. Precise LED selection ensures class leading colour rendering with interior enhancing colour temperatures in white (5000 K) or warm white (3000K). EuroLED lamps require no remote drivers or control wires, simply connect the positive and negative cables to 12V or 24V DC systems.

Each lamp operates on an input voltage between 10-33V DC and can also be fully dimmed and controlled via PWM based products such as the Hella marine Dimmer (5XA 998 572-001). Internal Multivolt™ electronics provide robust electronic protection for ongoing reliability including significant spike and reverse protection.

Completely sealed for interior and exterior installations, wet or dry, EuroLED lamps are the durable choice. Consumption ranges between 3-6W offering significant reductions in energy consumption and heat generation compared to incandescent lighting.



- Ultra low power consumption
- High colour rendering
- 316 stainless steel rims
- IP67 - Completely sealed
- Pre-wired with marine cable
- UV, corrosion and impact resistant
- Reverse polarity and spike protected
- 5 Year warranty



Hella marine 2 Group
Light Dimmer
5XA 998 572-001

Lamp Type		EuroLED 75	EuroLED 75 Dual Colour	EuroLED 95 Gen 2
Light Output @1m		100cd		420cd
Light Angle		80°		90°
Colour Temperature		5000 K (White) or 2700 K (Warm White)		
Lens Material		UV resistant enhanced impact acrylic		
Rim Material		UV resistant plastic or 316 stainless steel options		316 stainless steel
Cable		Pre-wired with marine cable		
Operating Voltage		12 or 24V DC	12V DC	Multivolt™ 12-24V DC
Power Consumption		<3W (<0.19A@12V)	<3W (<0.19A@12V)	<6W (<190mA@12V / <100mA@24V)
Degree of Protection		IP67 - Completely sealed	IP6K7 & IP6K9K - Completely sealed	IP6K9K - Completely sealed
Installation		Screw or Spring Mount		Spring Clip
Dimensions (WxHxD)	- mm	75 x 20.5 mm		95 x 30 mm
	- inches	2.95 x 0.81"		3.7 x 1.2"
Suit Hole Size		50 mm		76 mm
Weight (including cable)		45g		200g
Approvals		CE	CE, RCM	CE, RCM

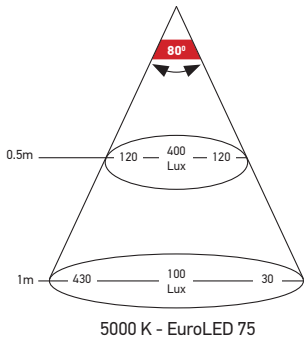

EuroLED 75 Down Lights

LED Colour	Mounting	Voltage	White Rim	Polished Stainless Steel Rim
White	Screw	12V DC	2JA 958 110-011	2JA 958 110-021
White	Screw	24V DC	2JA 958 110-111	2JA 958 110-121
White	Spring	12V DC	2JA 958 110-511	2JA 958 110-521
White	Spring	24V DC	2JA 958 110-611	2JA 958 110-621
Warm White	Screw	12V DC	2JA 958 109-011	2JA 958 109-021
Warm White	Screw	24V DC	2JA 958 109-111	2JA 958 109-121
Warm White	Spring	12V DC	2JA 958 109-511	2JA 958 109-521
Warm White	Spring	24V DC	2JA 958 109-611	2JA 958 109-621

Note: Bulk pack options are also available

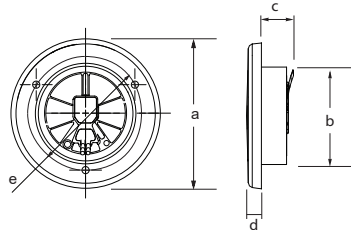

Dimensions:

- a = 72.0mm (2.83") with stainless rim
75.0mm (2.95") with plastic rim
- b = 52mm (1.96") with screw mounting
55.0mm (2.12") with spring mounting
- c = 16.0mm (0.63") with screw mounting
20.5mm (0.81") with spring mounting
- d = 7.5mm (0.29")
- e = 57.0mm (2.24") PCD

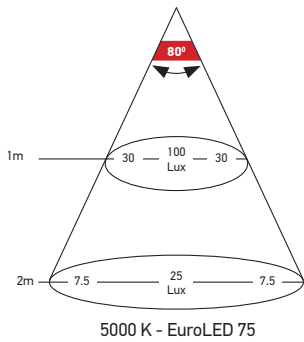

EuroLED 75 Dual Colour Down Lights

New

EuroLED75 DUAL COLOUR

LED Colour	Mounting	Voltage	White Plastic Rim	Stainless Steel Rim
Red/White	Screw	12V	2JA 015 247-011	2JA 015 247-021
Red/Warm White	Screw	12V	2JA 015 247-111	2JA 015 247-121
Red/White	Spring	12V	2JA 015 247-511	2JA 015 247-521
Warm White	Spring	12V	2JA 015 247-611	2JA 015 247-621

Note: Bulk pack options are also available

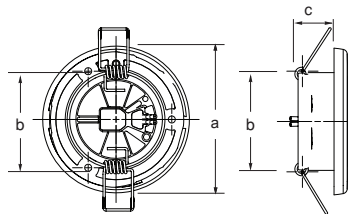

Dimensions:

- a = 72.0mm (2.83") with stainless rim
75.0mm (2.95") with plastic rim
- b = 50.0mm (1.96") with screw mounting
54.0mm (2.12") with spring mounting
- c = 16.0mm (0.63") with screw mounting
20.5mm (0.81") with spring mounting
- d = 7.5mm (0.29")
- e = 57.0mm (2.24") PCD

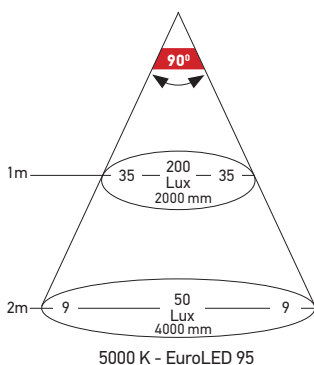

EuroLED 95 Gen 2 Down Lights - Spring Mounted

EuroLED95 GEN 2

LED Colour	Voltage	Single Blister Number	Bulk Pack of 12
Round Lamps			
White	12-24V DC	2JA 958 340-011	2JA 958 340-017
White/Red	12-24V DC	2JA 958 340-101	2JA 958 340-107
Warm White	12-24V DC	2JA 958 340-021	2JA 958 340-027
Warm White/Red	12-24V DC	2JA 958 340-121	2JA 958 340-127
Square Lamps			
White	12-24V DC	2JA 958 340-511	2JA 958 340-517
White/Red	12-24V DC	2JA 958 340-601	2JA 958 340-607
Warm White	12-24V DC	2JA 958 340-521	2JA 958 340-527
Warm White/Red	12-24V DC	2JA 958 340-621	2JA 958 340-627

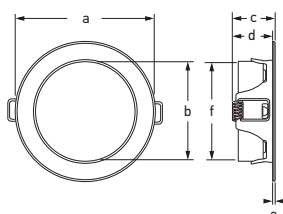

Dimensions:

- a = 95.0mm (3.7")
- b = 68.0mm (2.7")
- c = 30.0mm (1.2")
- d = 28.0mm (1.10")
- e = 2.0mm (0.08")
- f = 72.0mm (2.84") (Mounting Hole)

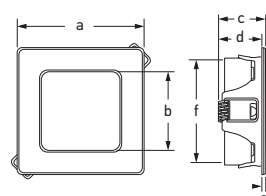

Dimensions:

- a = 78.0mm (3.1")
- b = 48.0mm (1.9")
- c = 30.0mm (1.2")
- d = 27.5mm (1.08")
- e = 2.5mm (0.1")
- f = 72.0mm (2.84") (Mounting Hole)

DOWN LIGHTING

Integrated switching and dual colour options in a stylish, efficient, reliable and completely sealed lamp suitable for both interior and exterior applications.



EuroLED 115



EuroLED 130



EuroLED 150

Lighting control with dual colour EuroLED Touch lamps is beautifully simple.

Touch the red pad for red light, the white pad for white light. Hold your finger on the pad and the lamp will cycle through increasing / decreasing intensity levels until the maximum / minimum intensity is reached. Remove finger on the desired light level.

Glare diffusion without light loss is important with any LED lamp to maintain efficiency and safety. Without the protection of advanced optics, significant eye strain can result from looking directly into an LED point source. Advanced Hella marine lens technology provides a safe, smooth and uniform light pattern without glare or discomfort.

Each EuroLED lamp is completely sealed and highly impact resistant for an ultra long service life.

Integrated Multivolt™ electronics provide consistent illumination and circuit protection across a range of input voltages from 9-33 DC, even under severe voltage fluctuations, low battery voltage and long cable runs.



- Ultra low power consumption
- High colour rendering
- 316 stainless steel rims
- IP67 - Completely sealed
- Pre-wired with marine cable
- UV, corrosion and impact resistant
- Reverse polarity and spike protected
- 5 Year warranty

Lamp Type	EuroLED 115	EuroLED 130	EuroLED 150
Light Output @1m	385cd	475cd	
Light Angle	36°	32°	
Colour Temperature	5000 K (White) or 3000 K (Warm White)		
Lens Material	UV resistant enhanced impact acrylic		
Rim Material	UV resistant plastic or 316 polished stainless steel		
Cable	Pre-wired with marine cable	Pre-wired with 2.5m marine cable	Pre-wired with 0.5m marine cable
Operating Voltage	10-33V DC	9-33V DC	
Power Consumption	<4W (<0.33A@12V / 0.17A@24V)		
Degree of Protection	IP67 - Completely sealed		
Installation	Recess or Surface with Spacer	Surface Mount	Recess or surface with spacer accessory
Product Dimensions (WxD)	117 x 22 mm / 4.59 x 0.87"	130 x 30 mm / 5.10 x 1.16"	150 x 25 mm / 5.90 x 1.0"
Suit Hole Size	90mm / 3.54"	N/A	124 mm / 4.88"
Weight (including cable)	170g	290g	245g
Approvals	CE		

EuroLED 115 Down Lights

LED Colour	Mounting	Voltage	White Rim	Polished Stainless Steel Rim
White	Screw	10-33V DC	2JA 980 820-001	2JA 980 820-011
Warm White	Screw	10-33V DC	2JA 980 820-101	2JA 980 820-111

EuroLED 115 Surface Mount with Switch

LED Colour	Mounting	Voltage	White Rim	Polished Stainless Steel Rim
White	Screw	10-33V DC	2JA 980 828-001	2JA 980 828-011
Warm White	Screw	10-33V DC	2JA 980 828-101	2JA 980 828-111

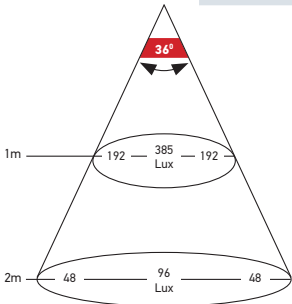

5000 K - EuroLED 115

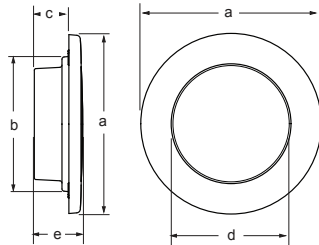

Dimensions

- a = 115.0mm / 4.53" plastic rim
- 117.0mm / 4.59" with stainless steel rim
- b = 90.0mm / 3.54"
- c = 22.0mm / 0.87"
- d = 77.0mm / 3.03"
- e = 31.5mm / 1.24"
- f = 100.0mm / 3.94" PCD



EuroLED 130 Down Lights with Switch

LED Colour	Switch Type	Voltage	White Shroud	Black Shroud
White / Red	Dual Colour Dimmable *	9-33V DC	2JA 959 950-121	2JA 959 950-111
White	On / Off	9-33V DC	2JA 959 950-521	2JA 959 950-511
White	No Switch	9-33V DC	2JA 959 820-521	2JA 959 820-511

* Dual colour EuroLED Touch 130 lamps with dimming and remote momentary switch control. Touch either colour pad for ON/OFF or hold finger on the pad to cycle through dim.

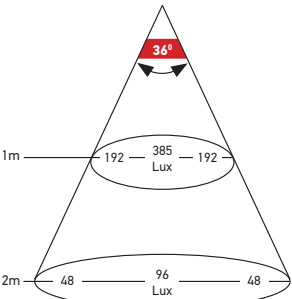

5000 K - EuroLED 130

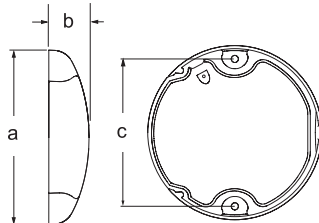

Dimensions

- a = 130mm / 5.10"
- b = 130mm / 1.16"
- c = 110mm / 4.33"

- Mounting bushes eliminate torque loads
- Nylon shroud clips onto lamp body



EuroLED 150 Down Lights with Switch

LED Colour	Switch Type	Voltage	White Rim	Polished Stainless Steel Rim
White / Red	Dual Colour Dimmable *	9-33V DC	2JA 980 630-001	2JA 980 630-011
White	On / Off	9-33V DC	2JA 980 630-501	2JA 980 630-511
White	No Switch	9-33V DC	2JA 980 631-501	2JA 980 631-511

* Dual colour EuroLED Touch 150 lamps with dimming and remote momentary switch control. Touch either colour pad for ON/OFF or hold finger on the pad to cycle through dim.

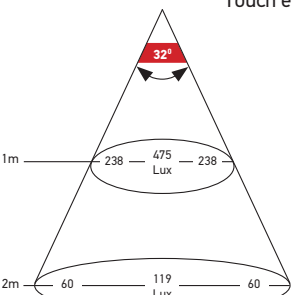

5000 K - EuroLED 150

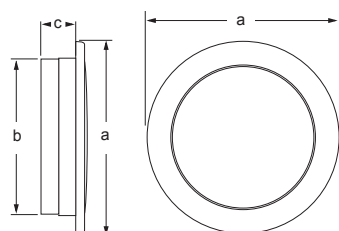

Dimensions

- a = 150mm / 5.90"
- b = 124mm / 4.88"
- c = 20.0mm / 0.79"



EuroLED130

EuroLED150

AC DOWN LIGHTING

Designed for cruise ship, river cruise, ferry and other commercial applications Hella marine has an extensive range of AC powered LED down lights.



Hella marine AC lighting systems are tailored for each vessel. For further information on these exciting LED developments please contact our specialists directly via info@hellamarine.com.



LED - Class Leading Efficiency

Combining efficient LED sources with advanced optic technology, Hella marine LED products deliver more light output per watt than incandescent based lamps with significant energy savings. Ultra low heat signatures reduce heat onboard and prevent damage to surrounding materials.

Electromagnetic Compatibility (EMC)

All Hella marine LED products are designed with components that suppress possible interference, both emission as well as susceptibility to emissions, to the limits prescribed in international standards. This prevents possible interference with radio, communication, navigation and other electrical equipment onboard.

Outstanding UV and Impact Resistance

Hella marine lamps utilise advanced impact resistant polymers that will not yellow or deteriorate in the harsh marine environment.

5 Year Warranty

All Hella marine LED based lighting products carry a 5 Year Warranty providing peace of mind that the product will stand the test of time.

- Ultra low power consumption
- High colour rendering
- 5 Year warranty

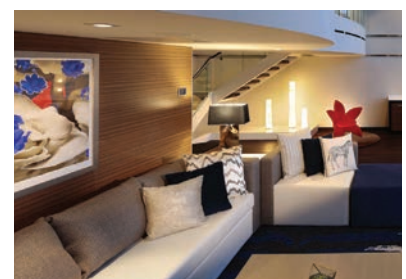

Lamp Type	S23	G100 i	S100 i
Light Output	330 lumens	450 lumens	350 lumens
Light Angle	50°	85°	15°, 40°, 60°, 90°
Color Temperature	2700 K, 3000 K, 4000 K		
Color Rendering Index	90 CRI	85 CRI	90 CRI
Dimmable	N/A	N/A	Yes
Power Consumption	4.5W	7.5W	6W
Degree of Protection	IP55	IP23 IP44	IP23
Product Dimensions (WxD)	80 x 21 mm	186 x 40 mm	115 x 60 mm
Suit Hole Size	48 mm	143 mm	102 mm

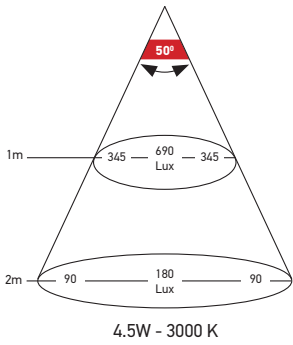

S23 Down Lights 4.5W				
Lens	Trim	2700 K	3000 K	4000 K
Clear	White	346.690-107	346.690-117	346.690-127
Clear	Satin	346.690-227	346.690-237	346.690-247
Clear	Black	346.690-167	346.690-177	346.690-187
Clear	Gold	346.690-287	346.690-297	346.690-307
Diffused	White	346.690-137	346.690-147	346.690-157
Diffused	Satin	346.690-257	346.690-267	346.690-277
Diffused	Black	346.690-197	346.690-207	346.690-217
Diffused	Gold	346.690-317	346.690-327	346.690-337

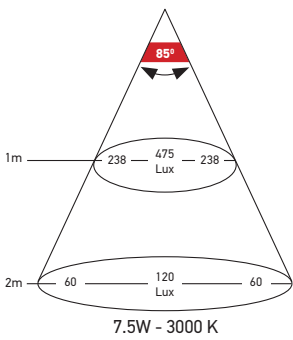
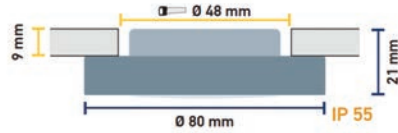

G100 i Down Lights 7.5W				
Wattage	IP Rating	2700 K	3000 K	4000 K
7.5W	IP 23	346.792-047	346.792-057	346.792-067
7.5W	IP 44	346.792-137	346.792-147	346.792-157
12.5W	IP 23	346.792-077	346.792-087	346.792-097
12.5W	IP 44	346.792-167	346.792-177	346.792-187

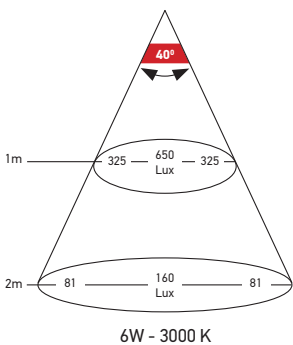
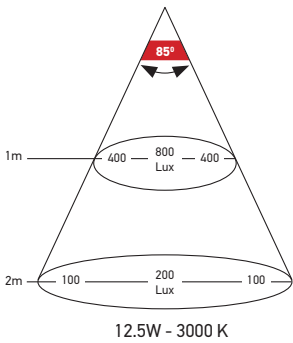
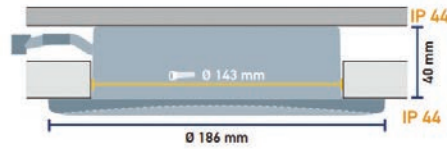

S100 i Down Lights 6W				
Lens	Trim	2700 K	3000 K	4000 K
90° diffused	White	346.750-247	346.750-067	346.750-157
90° diffused	Chrome	346.750-267	346.750-077	346.750-167
60°	White	346.750-257	346.750-007	346.750-097
60°	Chrome	346.750-217	346.750-037	346.750-127
40°	White	346.750-197	346.750-017	346.750-107
40°	Chrome	346.750-227	346.750-047	346.750-137
15°	White	346.750-207	346.750-027	346.750-117
15°	Chrome	346.750-237	346.750-057	346.750-147

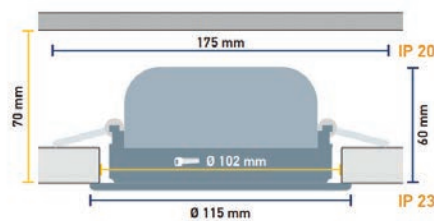
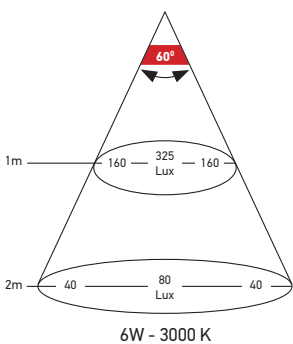

FLOODLIGHTING

Sleek and compact marine floodlights offer outstanding light intensity, class leading efficiency and proven durability.



Sea Hawk-R

Energy efficient Hella marine Sea Hawk lamps are completely sealed, lightweight and ultra durable, offering powerful illumination with significantly less consumption than halogen floodlights.

'Fit and Forget' for a long service life

Every aspect, material and component of a Sea Hawk lamp has been carefully chosen to ensure longevity in the most demanding conditions. The lens is precision moulded from high performance Grilamid® for strength and durability.

Unique Corrosion Proof Housing

Rather than being cast and machined from aluminium then protective coated, Sea Hawk-R housings are precision injection moulded from thermally conductive ceramic polymer. This advanced material draws heat from internal electronics for reliable long-term operation and eliminates the need for an aluminium housing in this class of floodlight, removing corrosion risks in the harsh marine environment.

Spread or Spot Optics

Spread lamps are ideal for the general illumination of cockpits and deck areas with a wide spread of crisp white light. Spot lamps offer a narrow concentrated beam with greater visible distance.



- IP67 - Completely sealed
- Ultra low power consumption
- UV, corrosion and impact resistant
- Pre-wired with marine cable
- Multivolt™
- Reverse polarity and spike protected
- 5 Year warranty

Lamp Type	Sea Hawk-R Bracket	Sea Hawk-R Recess
Light Output	550 lumens	
Light Angle	Spread 70° / Spot 20°	
Colour Temperature	5000 K (White)	
Lens Material	Heavy duty Grilamid	
Housing Material	'Non-metal' thermally conductive ceramic polymer	
Cable	Pre-wired with marine cable	
Operating Voltage	9-33V DC	
Power Consumption	7W (<0.58A@12V)	
Degree of Protection	IP67 - Completely sealed	
Installation	316 Stainless Steel Bracket Mount	Recess Mount
Product Dimensions (WxHxD)	136 x 53 x 49 mm / 5.35 x 2.08 x 1.93"	176 x 50 x 47 mm / 6.93 x 1.97 x 1.85"
Suit Hole Size	N/A	132 x 42 mm / 5.20 x 1.65"
Weight (including cable)	250g	187g
Approvals	CE	

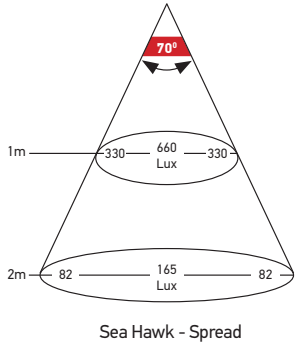

Sea Hawk-R LED Floodlights				
LED Colour	Lens Pattern	Voltage	Black Housing	White Housing
White	Spread	9-33V DC	2LT 980 573-011	2LT 980 573-021
Warm White	Spread	9-33V DC	2LT 980 573-051	2LT 980 573-061

Sea Hawk LED Floodlights				
LED Colour	Lens Pattern	Voltage	Black Housing	White Housing
Red	Spread	12V DC	2LT 980 670-341	2LT 980 670-351

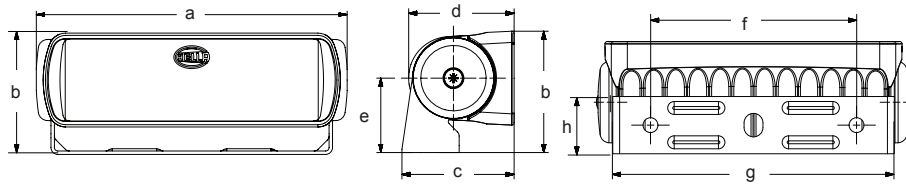

Dimensions

a = 136mm	/ 5.35"
b = 53.0mm	/ 2.08"
c = 49.0mm	/ 1.93"
d = 46.0mm	/ 1.81"
e = 32.5mm	/ 1.28"
f = 90.0mm	/ 3.54"
g = 123mm	/ 4.84"
h = 25.0mm	/ 0.98"

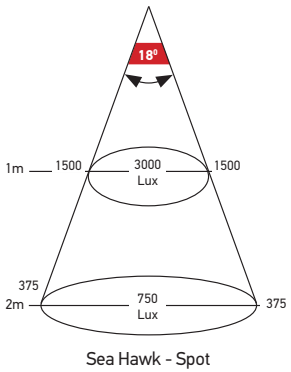

Sea Hawk-R LED Floodlights - Recessed				
LED Colour	Lens Pattern	Voltage	Black Housing	White Housing
White	Spread	9-33V DC	2LT 980 577-001	2LT 980 577-011
White	Spot	9-33V DC	2LT 980 577-201	2LT 980 577-211

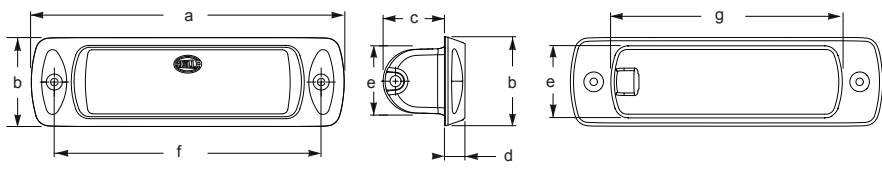

Dimensions

a = 176mm	/ 6.93"
b = 50.0mm	/ 1.97"
c = 35.0mm	/ 1.38"
d = 12.0mm	/ 0.47"
e = 42.0mm	/ 1.65"
f = 150mm	/ 5.91"
g = 132mm	/ 5.20"



FLOODLIGHTING

Sleek and compact marine floodlights offer outstanding light intensity, class leading efficiency and proven durability.

Sea Hawk-XL Dual Colour & Sea Hawk-XLR



Energy efficient Hella marine Sea Hawk lamps are completely sealed, lightweight and ultra durable, offering powerful illumination with significantly less consumption than halogen floodlights.



'Fit and Forget' for a long service life

Every aspect, material and component of a Sea Hawk lamp has been carefully chosen to ensure longevity in the most demanding conditions. The lens is precision moulded from high performance Grilamid® for strength and durability.

Unique Corrosion Proof Housing

Rather than being cast and machined from aluminium then protective coated, Sea Hawk-XL and Sea Hawk-XLR housings are precision injection moulded from thermally conductive ceramic polymer. This advanced material draws heat from internal electronics for reliable long-term operation and eliminates the need for an aluminium housing in this class of floodlight, removing corrosion risks in the harsh marine environment.

Spread or Spot Optics

Spread lamps are ideal for the general illumination of cockpits and deck areas with a wide spread of crisp white light. Spot lamps offer a narrow concentrated beam with greater visible distance.

- IP67 - Completely sealed
- Ultra low power consumption
- UV, corrosion and impact resistant
- Pre-wired with marine cable
- Multivolt™
- Reverse polarity and spike protected
- 5 Year warranty

Lamp Type	Sea Hawk-XL	Sea Hawk-XLR
Light Output	850 lumens (White)	1500 lumens
Light Angle	Spread	Spread/Spot
Dimmable	Not Available	High / Low modes
Colour Temperature	Primary 5000 K (White) , Secondary Warm White (2700 K), Red, Blue	5000 K (White)
Lens Material	Heavy duty Grilamid	
Housing Material	'Non-metal' thermally conductive ceramic polymer	
Cable	Pre-wired with 2.5m marine cable	
Operating Voltage	9-33V DC	
Power Consumption	White: <12W (<1A@12V) Red: <2.0W (0.166A@12V)	High: 18W (<1.5A@12V) Low: 2W (<0.17A@12V)
Degree of Protection	IP67 - Completely sealed	
Installation	Upright or Pendant mounted with 316 Stainless Steel Bracket	
Product Dimensions (WxHxD)	170 x 68 x 58 mm / 6.69 x 2.68 x 2.28"	
Weight (including cable)	750g	
Approvals	CE	



SEA HAWK-XL

DUAL COLOUR LED FLOODLIGHTS

Sea Hawk-XL Dual Colour LED Floodlights

LED Colour	Lens Pattern	Voltage	Black Housing	White Housing
White / Red	Spread	9-33V DC	2LT 980 950-041	2LT 980 950-051
White / Warm White	Spread	9-33V DC	2LT 980 950-081	2LT 980 950-091
White / Blue	Spread	9-33V DC	2LT 980 950-061	2LT 980 950-071

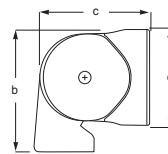
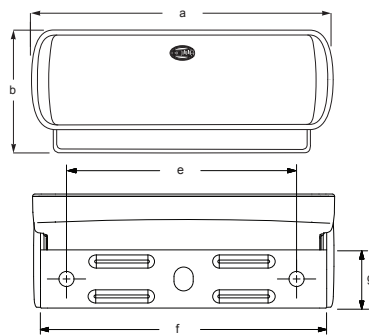
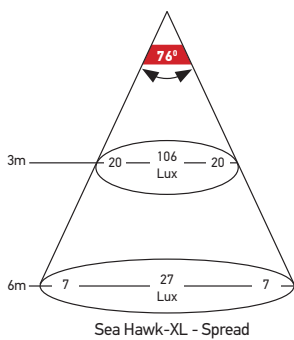

- Dimensions**
- a = 170mm / 6.69"
 - b = 68.0mm / 2.68"
 - c = 58.0mm / 2.28"
 - d = 55.0mm / 2.17"
 - e = 120mm / 4.72"
 - f = 154mm / 6.06"
 - g = 30.0mm / 1.18"



Sea Hawk-XLR LED Floodlights

LED Colour	Lens Pattern	Voltage	Black Housing	White Housing
White	Spread	9-33V DC	2LT 980 740-001	2LT 980 740-011
White	Spot	9-33V DC	2LT 980 740-201	2LT 980 740-211

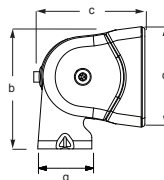
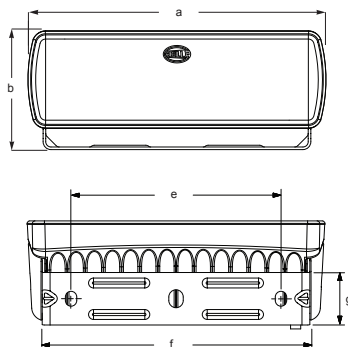
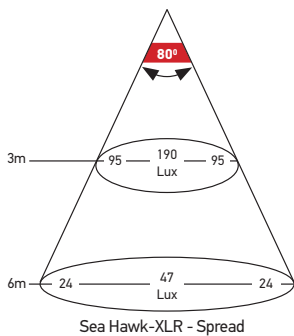

- Dimensions**
- a = 170mm / 6.69"
 - b = 68.0mm / 2.68"
 - c = 58.0mm / 2.28"
 - d = 55.0mm / 2.17"
 - e = 120mm / 4.72"
 - f = 154mm / 6.06"
 - g = 30.0mm / 1.18"



FLOODLIGHTING

High output marine floodlights in a sleek and versatile design offer outstanding light intensity, class leading efficiency and proven durability.

Sea Hawk LED Light Bars



Hella marine's popular Sea Hawk-350 and Sea Hawk-470 LED light bar floodlights feature an easy to install bracket assembly. These simply clip onto the ends of the light bar which can then be mounted upright or pendant to accommodate most applications. The nuts, bolts and mounting brackets are all made from marine grade 316 stainless steel.

Bright and efficient

The Sea Hawk-350 and Sea Hawk-470 LED light bar floodlights generate over 2200 lumens of crisp, white light to illuminate the hardest to see places while continuing the durability and efficiency advantages accustomed to the proven Sea Hawk range.

Engineered light patterns

Advanced optical systems deliver incredible illumination without glare. Spread lamps illuminate a wide, close-range spread over a cockpit, foredeck or working area. Spot lamps provide a more concentrated illumination for tuna towers, yacht masts or forward facing lighting on a variety of applications.

Unique corrosion proof housing

Sea Hawk-350 and Sea Hawk-470 housings are precision injection moulded from thermally conductive ceramic polymer. This advanced material draws heat from internal electronics for reliable long-term operation and eliminates the need for an aluminium housing removing corrosion risks in the harsh marine environment.



- High performance LEDs
- 2200-3600 lumen actual output
- Low power consumption
- Engineered optic designs for versatility
- Thermally conductive 'non-metal' housing
- Completely sealed
- Pre-wired with 2.5m marine tinned cable
- Multivolt™ 9-33V DC
- 5 Year warranty

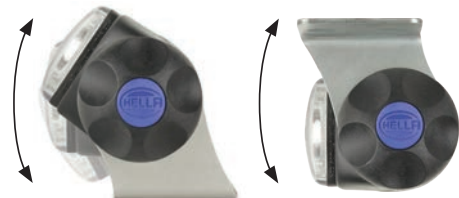

Friction fitted clamp enables lamp to be easily adjusted to illuminate at various angles. Versatile 316 Stainless Steel bracket design allows upright or pendant mount with feet aimed in or out.

Lamp Type	Sea Hawk-350 LED Light Bar	Sea Hawk-470 LED Light Bar			
	Spread or Spot	Combi	Spot	Spread	Wide Spread
Light Output	2200 lumens	2200 lumens	2800 lumens		3600 lumens
Power Consumption	High Intensity 25W (2A@12V / 1A@24V) Low Intensity 5W	36W	High Intensity 36W Low Intensity 4W		
Housing Material	'Non metal' Thermally conductive ceramic polymer housing				
Lens Material	Heavy duty Grilamid lens				
Mounting Brackets	316 Stainless Steel Brackets. Upright or pendant				
Colour Temperature	5000 K (White)				
Cable	Pre-wired with 2.5m of triple core marine cable				
Operating Voltage	Multivolt 9-33V DC				
Degree of Protection	IP6K7 / IP6K9K - Completely Sealed				
Weight	580g (including cable)	950g (including cable)			
Approvals	CE, RCM				

Sea Hawk-350

Sea Hawk-350 LED Light Bar				
LED Colour	Lens Option	Voltage	Black Housing	White Housing
White	40° Spread	9-33V DC	2LT 958 040-701	2LT 958 040-711
White	10° Spot	9-33V DC	2LT 958 040-651	2LT 958 040-661

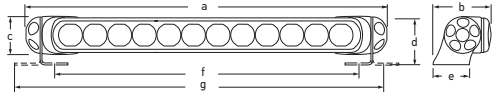

Dimensions
 a = 408mm / 16.06"
 b = 67mm / 02.64"
 c = 44mm / 01.73"
 d = 57mm / 02.24"
 e = 42mm / 01.65"
 f = 340mm / 13.38" (Mounting Hole)
 g = 404mm / 15.91" (Mounting Hole)

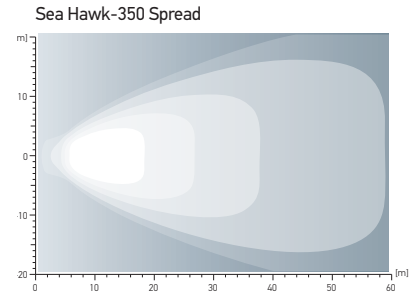
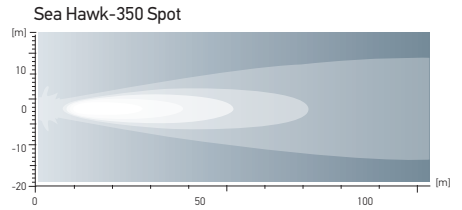

Sea Hawk-470

Sea Hawk-470 Combi (Spread and Spot) LED Light Bar			
LED Output	Power Consumption	Black Housing	White Housing
2200 lumen	36W	2LT 958 130-441	2LT 958 130-451

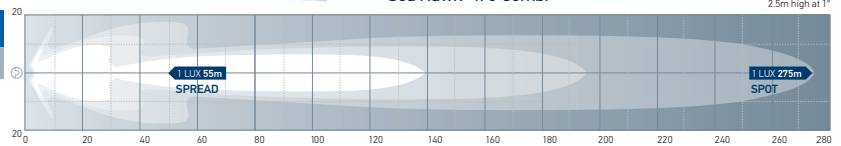

Sea Hawk-470 Spot LED Light Bar			
LED Output	Power Consumption	Black Housing	White Housing
2800 lumen	High: 36W	2LT 958 130-631	2LT 958 130-641

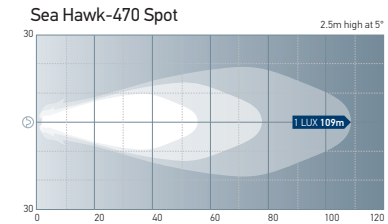

Sea Hawk-470 Spread LED Light Bar			
LED Output	Power Consumption	Black Housing	White Housing
2800 lumen	High: 36W	2LT 958 130-601	2LT 958 130-611

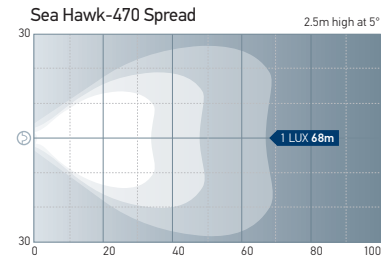

Sea Hawk-470 Wide Spread LED Light Bar			
LED Output	Power Consumption	Black Housing	White Housing
3600 lumen	High: 36W	2LT 958 130-501	2LT 958 130-511

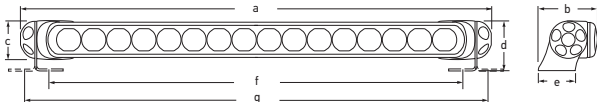
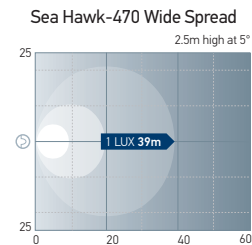

Individual lamp dimensions with supplied brackets

Dimensions:
 a = 528mm / 20.79"
 b = 67mm / 02.64"
 c = 44mm / 01.73"
 d = 57mm / 02.24"
 e = 42mm / 01.65"
 f = 460mm / 18.11" (Mounting Hole)
 g = 524mm / 20.63" (Mounting Hole)

Accessories for Sea Hawk Lamps	
Description	Part Number
Double Stack Mounting Brackets	8HG 958 128-811
100W 24V IP67 AC-DC Power Supply	8ES 910 345-041

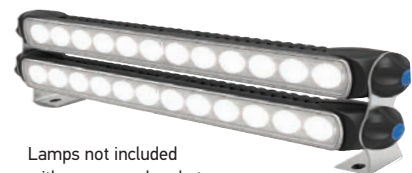

Lamps not included with accessory brackets

The optional double bracket accessory enables you to stack multiple lamps. Either increase the light output or mix different optic options for multiple applications or a more dynamic light output.

FLOODLIGHTING

Traditional marine LED floodlights offer outstanding light intensity and a single mounting bracket.

Module 70 & Handheld Search Light



Close range floodlights with the energy saving advantages of Hella marine LED technology.

Multivolt™ 9-30V DC

Advanced electronics ensure reliable illumination and lamp protection even under severe voltage fluctuations and low battery voltages.

Pre-wired with marine cable

High quality sealed cable assemblies for time saving, completely sealed installations.

Designed and manufactured in Austria

Hella marine Module 70 lamps carry a 5 year warranty.



- 800 lumen actual output
- Low power consumption (from 13W)
- Completely sealed
- Pre-wired with 2.5m marine tinned cable
- 5 Year warranty

Lamp Type	LED Module 70 (Gen 3)	LED Module 70 (Gen 4)	Handheld Search Light
Light Output	800 lumens	2100 lumens	2500 lumens
Material Description	Die cast aluminium body, glass lens		
Bracket/Handle Material	316 stainless steel bracket		Plastic handle
Colour Temperature	6500K		
Cable	Pre-wired with 2.0m of twin core marine cable		Spiral cable with cigarette lighter plug (extended length 3.5m)
Operating Voltage	Multivolt™ 9-30V DC		Multivolt™ 12 / 24V DC
Degree of Protection	IP67 - Completely sealed		IP6K9K, IP6K8
Power Consumption	13W	21W	30W
Dimensions	110mm (w) x 83mm (h) x 74mm (d)		160 (w) x 145 (h) x 83mm (d)
Weight (including cable)	750g	500g	1,000g
Approvals	CE		



LED Module 70 (Gen 3)

Lens Type	Black Housing	White Housing
Close Range	1G0 996 276-452	1G0 996 276-471
Power Consumption	13W	
Light Output	800 lumens	
Dimensions (H, W, D)	110 x 83 x 74mm (including bracket)	

13W 800 Lumens

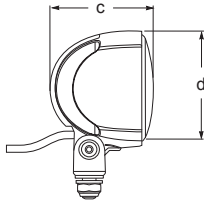
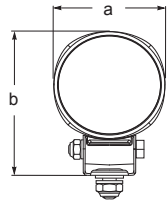

Dimensions
 a = 83.0mm / 3.27"
 b = 110mm / 4.33"
 c = 74.0mm / 2.91"
 d = 83.0mm / 3.27"

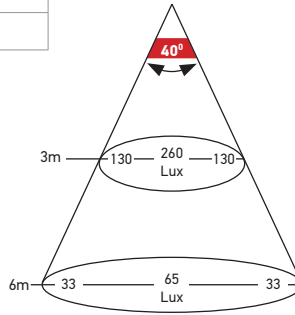

Module 70 Gen 3 - 5000 K



LED Module 70 (Gen 4)

Lens Type	Black Housing	White Housing
Close Range	1G0 996 476-541	1G0 996 476-521
Long Range	1G0 996 476-551	1G0 996 476-531
Power Consumption	21W	
Light Output	2100 lumens	
Dimensions (H, W, D)	110 x 83 x 74mm (including bracket)	

21W 2100 Lumens

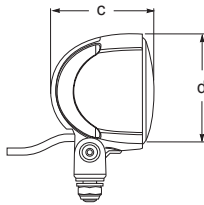
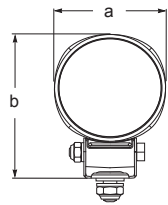

Dimensions
 a = 83.0mm / 3.27"
 b = 110mm / 4.33"
 c = 74.0mm / 2.91"
 d = 83.0mm / 3.27"

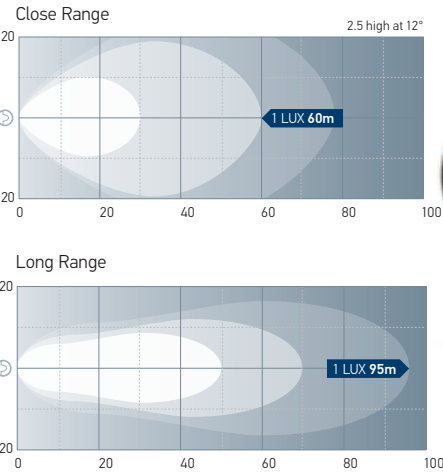

Handheld Search Light

Range	Black Housing
Long range / Spot	1H0 996 476-502
Close range / Spread	1H0 996 476-512
Accessories	Part Number
Deck mount base	8HG 998 519-001
Housing Description	Premium Corosafe coating
Light Output	2500 lumens
Operating Voltage	Multivolt 12 / 24V DC
Power Consumption	30W
Cable	Spiral cable with cigarette lighter plug (extended length 3.5m)
Degree of Protection	IP6K9K and IP6K8

30W 2500 Lumens



Deck mount
 base accessory
 P/N 8HG 998 519-001

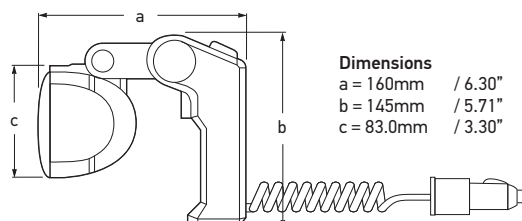
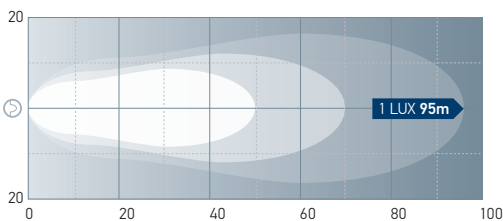

Dimensions
 a = 160mm / 6.30"
 b = 145mm / 5.71"
 c = 83.0mm / 3.30"

WORK LAMPS

High output, extremely versatile heavy duty work lamps ideal for use on commercial marine vessels.

Power Beam & RokLUME 280



Relentless Hella marine 'test to destruction' development programmes have lifted product reliability to new levels. RokLUME 280 and Power Beam lamps endure the worst of vibration, shock and high impact torture tests.

Hella's optical engineering expertise provides highly effective illumination for working vessels. Option of two light patterns, close range or long range beam patterns offer a crisp white 'close to daylight' 5000 K colour temperature. Working under this colour of light reduces the fatigue and eye strain sometimes caused by warmer colour halogen lighting.

Electromagnetic Compatibility (EMC) is an increasingly relevant safety concern for many emergency and industrial applications. As electronic devices such as LED lamps become more common, so does the risk of unintended electromagnetic interference (EMI) that can have adverse effects on other sensitive devices such as radios or communication equipment.



- IP6K9K - completely sealed
- Heavy duty stainless steel mount
- Aluminium housing with protective coating
- UV, corrosion and impact resistant
- 5 Year warranty
- Made in Austria



Solid 316 stainless steel multi-adjustable bracket firmly holds the lamp to withstand harsh vibration and impact.

Lamp Type	RokLUME 280	Power Beam
Light Output	4400 lumens	6000 lumens
Material Description	Aluminium housing with NanoSafe coating	Aluminium body, Hard-coated polycarbonate lens
Bracket/Handle Material	316 stainless steel bracket	
Colour Temperature	5000 K	
Cable	DT socket (counter plug supplied)	2m Double insulated silicone supply cable with bare ends
Operating Voltage	Multivolt™ 9-30V DC	24V
Degree of Protection	IP6K8 & IP6K9K	
Power Consumption	56W	65W
Dimensions	148 x 179 x 102mm (including bracket)	143 x 133 x 85mm (including bracket)
Warranty	5 years	
Approvals	ECE R10, RCM	RCM, CE, EMC

RokLUME 280 LED WORK LAMPS

New

56W 4400 Lumens

Lens Type	Part Number
Close Range	1GA 995 606-501
Long Range	1GA 995 606-511

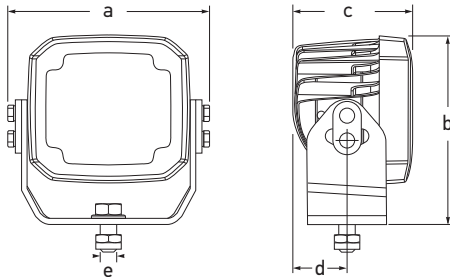

Dimensions:
 a = 143mm / 5.61"
 b = 133mm / 5.24"
 c = 85mm / 3.35"
 d = 38mm / 1.5"
 e = 10mm / 0.39"



BEAM PATTERNS

RokLUME 280 - Close Range

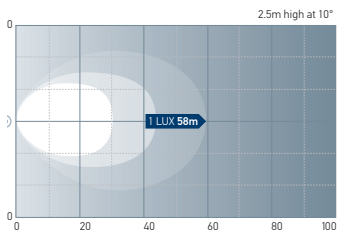

RokLUME 280 - Long Range

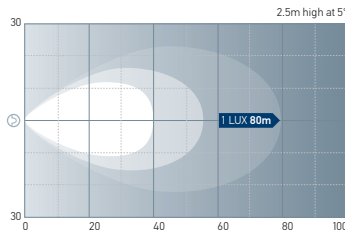

Power Beam Heavy Duty LED Floodlights

Lens Pattern	Voltage	Part Number
Close Range	24V DC	1GA 996 197-661
Long Range	24V DC	1GA 996 197-671

65W 6000 Lumens

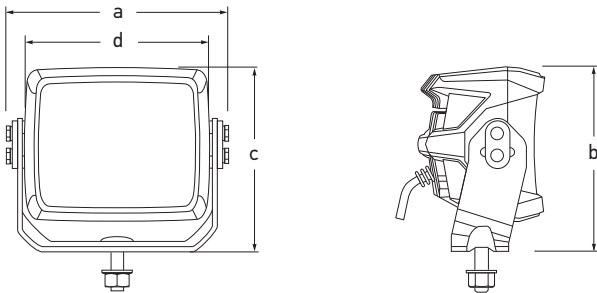

Dimensions:
 a = 179mm / 7.05"
 b = 148mm / 5.8"
 c = 148mm / 5.8"
 d = 145mm / 5.7"



BEAM PATTERNS

Power Beam - Close Range

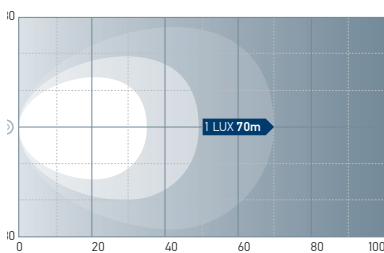

Power Beam - Long Range

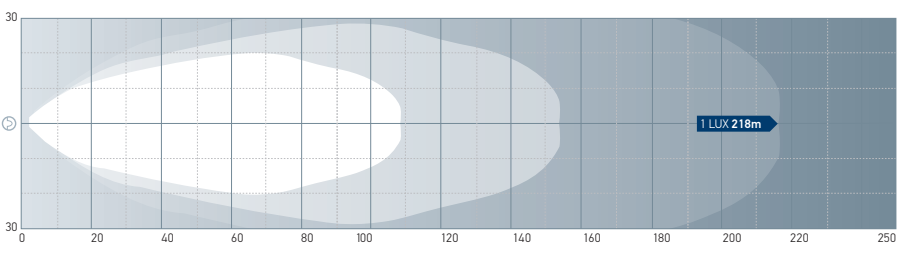

Accessories for Work Lamps

Description	Part Number
100W 24V IP67 AC-DC Power Supply	8ES 910 345-041
2.5m cable with DT Plug	9.1549.05



WORK LAMPS

20,000 + lumens of pure bright white light in a ultra durable housing with heavy duty 316 stainless steel mounting bracket.

HypaLUME



A quantum technology leap for commercial vessels, HypaLUME is Hella marine's most powerful floodlight.



Hypa-Performance

Powerful optical system generates over 25,000 lumens for a mere 260W consumption (10A@24V) offering class leading efficacy. With this impressive output, HypaLUME provides usable light comparable to a metal halide fitting for significantly less energy consumption.

- Heavy duty Grilamid lens
- IP6K9K - completely sealed
- UV, corrosion and impact resistant
- High and low light output
- Bracket allows vertical angle adjustment
- 5 Year warranty

Engineered reliability

Completely sealed (IP6K9K) housings are impervious to moisture and contaminants. HypaLUME development programs had endured arduous torture tests of harsh vibration, impact, thermal shock, deluge testing, EMC bursts, accelerated corrosion and harsh chemical exposure.

Designed and manufactured in New Zealand.

HypaLUME lamps carry a 5 year warranty.



Front view

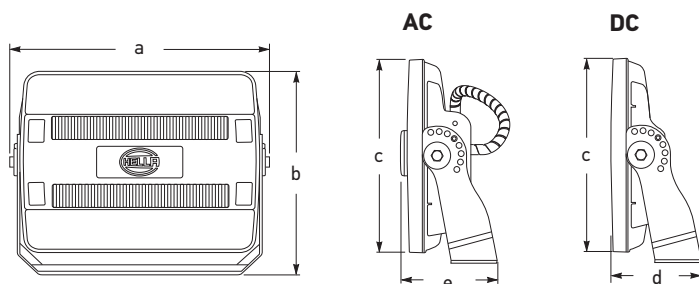

DIMENSIONS

110/230V AC	24/48V DC
a = 520mm (20.47")	a = 520mm (20.47")
b = 380mm (15.9")	b = 380mm (15.9")
c = 359mm (14.13")	c = 359mm (14.13")
e = 180mm (07.08")	d = 166mm (06.54")

Lamp Type	HypaLUME 110/230V AC LED	HypaLUME 24/48V DC LED	HypaLUME Amber 24/48V DC LED
Light Output	28000 lumens	25000 lumens	19000 lumens
Housing Material	Die cast aluminium body. Non-stick surface coating		
Lens Material	Heavy duty Grilamid		
Bracket	316 stainless steel		
Colour Temperature	5700 K (Daylight White)		2500 K (Amber)
Cable	Pre-wired with 2.0m of twin core marine cable	Pre-wired with 1.8m of twin core marine cable	Supplied with 1.8m of easy plug-in sheathed cable
Operating Voltage	Multivolt™ 100-240V AC	Multivolt™ 21-52V DC	22 to 52V DC
Degree of Protection	IP66 and IP6K9K - Completely Sealed	IP6K9K - Completely Sealed	IP6K7 and IP6K9K
Power Consumption	300W	260W	260W
Operating Temperature	-40°C to + 50°C		
Weight	13.3 Kg (including cable)		
Vibration Rating	750Hz at 3.2mm		
Approvals	CE, C-Tick, CISPR25 Class 2, ISO13766:2006		CE, C-Tick, FCC, ISO13766, ECE R10

HypaLUME 110/230V AC LED Floodlight

Lens Type	Part Number
Close Range	1GJ 958 334-011
Long Range	1GJ 958 334-021
Extra Wide	1GJ 958 334-031

300W 28,000 Lumens



Side view



Rear view

Beam Pattern - Close Range

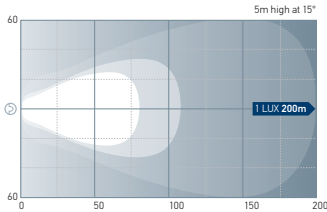

Beam Pattern - Extra Wide

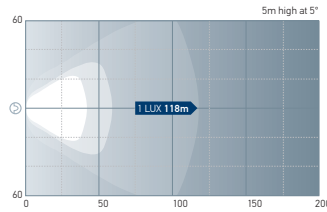

Beam - Pattern - Long Range

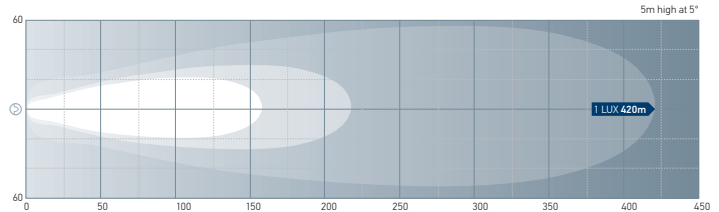

HypaLUME 24/48V DC LED Floodlight

Lens Type	Part Number
Close Range	1GJ 011 872-501
Long Range	1GJ 011 872-511
Extra Wide	1GJ 011 872-521

260W 25,000 Lumens



Side view

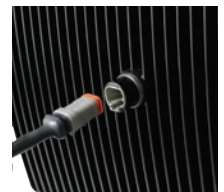

DT connection

Beam Pattern - Close Range

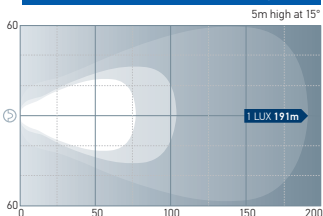

Beam Pattern - Extra Wide

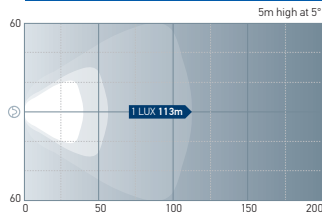

Beam - Pattern - Long Range

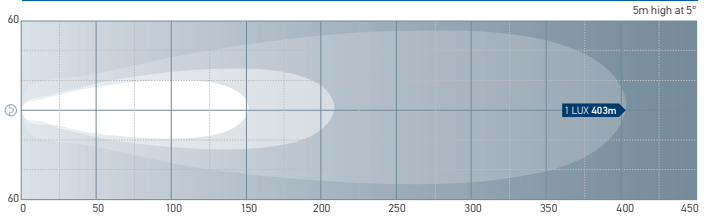

HypaLUME Amber 24/48V DC LED Floodlight

New

Lens Type	Part Number
Close Range	1GJ 011 872-601
Long Range	1GJ 011 872-611
Extra Wide	1GJ 011 872-621

260W 19,000 Lumens



Side view

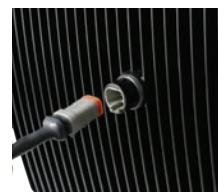

DT connection

Beam Pattern - Close Range

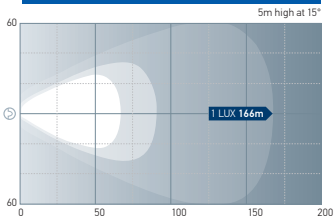

Beam Pattern - Extra Wide

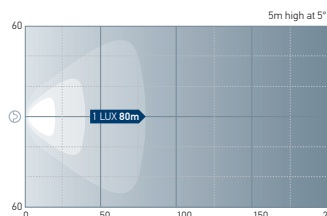

Beam - Pattern - Long Range

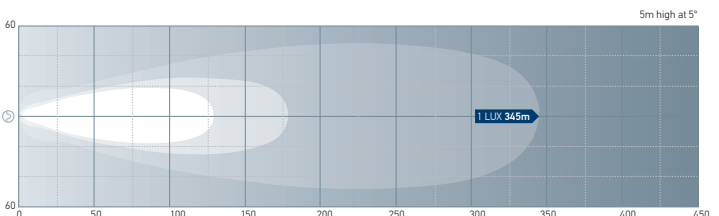

SIGNAL LAMPS

LED Multi-flash Signal Lamps



Multi-purpose signal lamps with robust housings, 10 programmable flash modes and the ability to be synchronised to flash alternately or in unison.

Each lamp is a completely sealed unit. Proven design, precision engineering and the use of high impact acrylic materials ensure superior resistance to water, impact, UV and wear and tear.

Advanced Multivolt™ circuitry provides reliable illumination across a range of DC inputs from 9-33 volts even during low battery voltages and voltage drop over long cable runs.

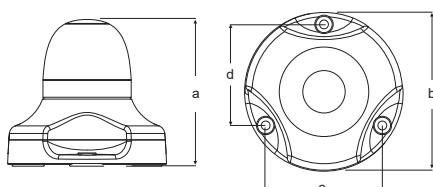

Dimensions:
 a = 83mm / 3.27"
 b = 90mm / 3.54"
 c = 66mm / 2.60" (mounting holes)
 d = 57mm / 2.24" (mounting holes)

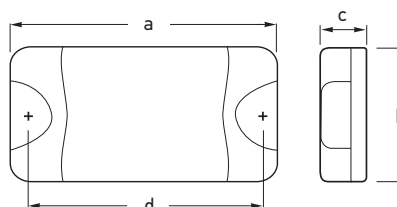

Dimensions:
 a = 177mm / 6.97"
 b = 100mm / 3.94"
 c = 30.0mm / 1.18"
 d = 148mm / 5.83"

360° Multi-flash Signal Lamps

Light Colour	Part Number
White	2XD 980 911-001
Green	2XD 980 911-201
Red	2XD 980 911-401
Amber	2XD 980 911-601
Blue	2XD 980 911-701

DuraLED® Multi-flash Signal Lamps

Light Colour	Part Number
White	2XD 959 037-911
Green	2XD 959 037-811
Red	2XD 959 037-011
Amber	2XD 959 037-111
Blue	2XD 959 037-611

Lamp Type	360° Multi-flash Signal Lamps	DuraLED Multi-flash Signal Lamps
Material Description	Ultra heavy duty Grilamid® lens	Heavy duty acrylic lens
Cable	Pre-wired with 2.5m of multi core cable	
Operating Voltage	Multivolt™ 9-33V DC	
Voltage Protection	Spike protected to +500 volts, Reverse polarity protected to -700 volts	
Power Consumption	<5W (<0.42A@12V / <0.021A@24V (Continuously on) Less in flash modes	<9W (<0.75A@12V / <0.375A@24V (Continuously on) Less in flash modes
Degree of Protection	IP67 - Completely sealed	
Weight (including cable)	150g	345g
Approvals	CE	

LED BEACONS

Flashing LED Warning Lamps

RotaLED



The new RotaLED Compact flashing beacon is a complete warning solution, in a cost effective package. It offers a high level of durability and a maintenance free design.

A high performance LED beacon offering a double flash signal and 360° warning effect provides ultimate attention for any application. The impact resistant dome and no moving parts give maximum reliability in work site conditions.

The RotaLED Compact beacon offers a Fit & Forget solution that is covered by an extensive 5 year warranty for complete peace of mind.

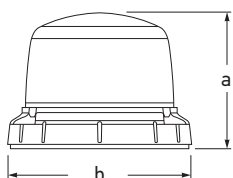

Dimensions:
a = 118mm / 4.64"
b = 165mm / 6.50" Ø

RotaLED Compact Amber Flashing LED Beacon

Lens Type	Part Number
Amber Lens	2XD 013 979-001



- Double-flash signal over 360° for maximum warning effect
- Low power consumption of 10W
- Advanced LED technology means no moving parts
- Impact-resistant dome



This passenger vessel features a RotaLED compact beacon



Lamp Type	RotaLED Compact Amber Flashing LED Beacon		
Mounting	Fixed mounting on horizontal surfaces		
Operating Voltage	Multivolt™ 10-30V DC		
Power Consumption	10W		
Voltage Protection	Reverse polarity and Transient Spike Circuit protection		
Degree of Protection	IP67 (Protection against dust and temporary water immersion)	IPX9K (Protection against high-pressure cleaner, specific for road vehicles)	
Flash Rate	124 +/- 10 per minute, double flash		
RF Suppression	CISPR25 Class 5		
Compliance	ECE R65/00 TA1	ECE R10	SAE J845 Class 2 

ACCESSORIES

Turbo Fans & Switches



Turbo Fans

Hella Turbo fans may be turned and pivoted in all directions and locked into position.

- Quality German motor provides very quiet operation
- 150mm diameter fan blade with guard
- High air moving capacity with low power consumption
- Two speed switch in front of the blade guard
- Side, upright or pendant mounting

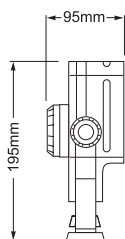
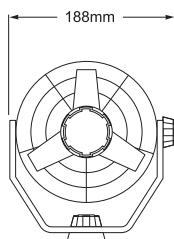

Voltage	Housing Colour	Part Number
12V	Black Housing	8EV 003 361-002
12V	White Housing	8EV 003 361-022
24V	Black Housing	8EV 003 361-012

Material Description	Impact resistant plastic
Switch	Integrated 2 stage rotary
Output	Speed 1: 70 litre/sec. Speed 2: 95 litre/sec.
Power Consumption	6.5W
Installation	Pre-wired with 140mm of cable

LED Illuminated Switches

Exterior durable, stainless steel switches featuring a ring of LED light. Manufactured from 304 stainless steel, these through panel mount switches are IP67 rated when installed and ideal for switching lighting or installing into custom switch panels. The light rings may be wired to show power to a system or signal circuit activation.

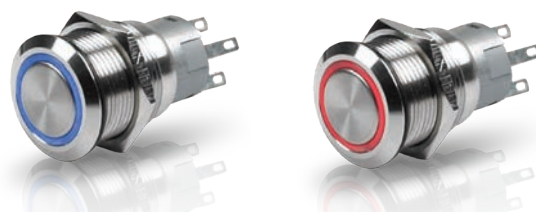

Stainless Steel Switches with LED Ring - Latching

Light Colour	Voltage	Operation	Part Number
Red	12V DC	On / Off	8HG 958 455-001
Blue	12V DC	On / Off	8HG 958 455-011
Red	24V DC	On / Off	8HG 958 455-101
Blue	24V DC	On / Off	8HG 958 455-111

Stainless Steel Switches with LED Ring - Momentary

Light Colour	Voltage	Operation	Part Number
Red	12V DC	Momentary	8HG 958 455-201
Blue	12V DC	Momentary	8HG 958 455-211
Red	24V DC	Momentary	8HG 958 455-301
Blue	24V DC	Momentary	8HG 958 455-311

Material Description	304 Stainless Steel
Contact Material	Silver Alloy
Terminal Type	5 Pin (2.8 x 0.5mm) switches
Panel Thickness	1~ 10mm
Insulation Resistance	≥ 1000MΩ
Contact Resistance	≤ 50mΩ
Operating Temp	-20°C~ +55°C
Max. Switch Rating	5A
Protection	IP67 Completely sealed
Buzzer sound intensity	>80dB (1m)

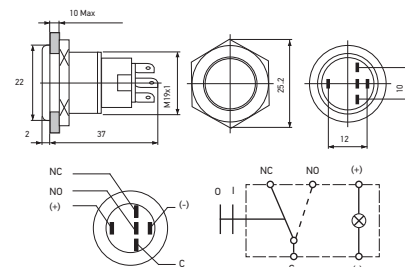



HypaLUME

HELLA MARINE'S
MOST POWERFUL
LED FLOODLIGHT

FOR MORE INFORMATION GO TO PAGE 26



Hella marine 
www.hellamarine.com

- LED
- IP67 COMPLETELY SEALED
- UV RESISTANT
- 5 YR WARRANTY
- MADE IN NZ

Hella marine

Vision and Innovation



Hella marine Europe

HELLA BENELUX BV
Celsiusbaan 2
Nieuwegein 3439
Netherlands

Phone +31 30 60 95 611

Email bnl.info@hella.com

Hella marine USA

HELLA INC
201 Kelly Drive
PO Box 2665
Peachtree City, GA 30269
USA

Phone (770) 631-7500

Email soe.sales@HINC.hella.com

Hella marine Australia

HELLA Australia Pty. Ltd.
4 Hargrave Place, Mentone,
Victoria. 3194 P.O. Box 89,
Mentone. 3194
Australia

Phone (03) 9581 9333

Email custservice@ha.hella.com

Hella marine New Zealand

HELLA New Zealand Limited
81-83 Ben Lomond Crescent
Pakuranga 2140
Auckland
New Zealand

Phone +64 9 577 0000

Email info@hellamarine.com



For the most up to date product range and technical information visit us online

www.hellamarine.com

- Latest products
- News
- Catalogues
- Instruction sheets and more

Follow us on



www.facebook.com/hellamarine

www.linkedin.com/company/hella-marine

www.youtube.com/user/hellamarine

